

Emergency LED Driver

BLD-CM08H-YYY BLD-CM15H-YYY BLD-CM20H-YYY

Features:

- Meets standards CSA C22.2 NO.141and UL 924
- External lithium battery
- Battery protections : over charge protection, over discharge protection
- Indicator shows a variety working modes
- The batteries meet 500 cycles of standard charge and discharge
- RoHS compliant



Specifications:

Universal Input Voltage

100-347Vac, 50/60Hz

AC Input Current

100mA max.

AC Input Power Rating

7.0W max.

Output Voltage

36-150Vdc

Emergency Time

1.5H

Full Warranty

5 Years

Test Switch Indicator Light

Illuminated Test Switch, indicator Light

Battery Charging Current

≤350mA

Charging Time

24Hours

Temperature Rating (Ambient)

0°C to +50°C (32°F to 122°F)

Operation:

AC Operation:

AC power is present, The LED load from the LED driver is normal power supply, the emergency driver is charging in a standby mode, The green/red LED light on to indicate that it is charging.

Emergency operation:

When the AC power goes out, The emergency driver detects the AC power outage and automatically switch to the working emergency mode. The green /red LED light off. When the AC power is restored, the emergency driver backs to AC power working and starts re-charging, the green /red LED light on.

Output Power	8W	15W	20W
---------------------	-----------	------------	------------

Wiring Diagram:

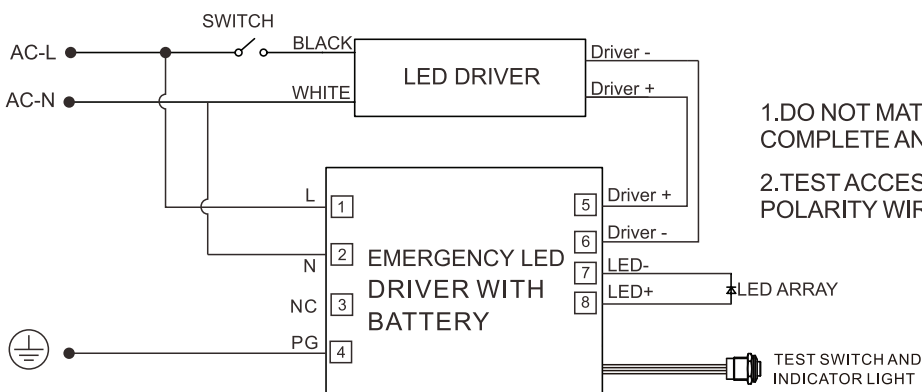

1. DO NOT MATE CONNECTOR UNTIL INSTALLATION IS COMPLETE AND AC POWER IS SUPPLIED.

2. TEST ACCESSORY LEADS-OBSERVE PROPER POLARITY WIRING.

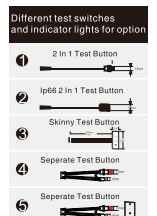

Emergency LED Driver

BLD-CM08H-YYY BLD-CM15H-YYY BLD-CM20H-YYY

Dimensions:

Case-7.4"x1.5"x1.14"(mounting center-7.0")

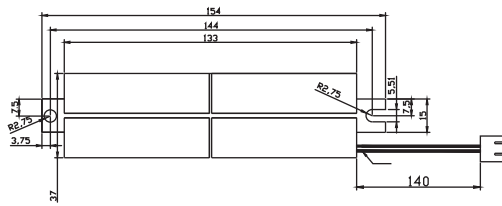
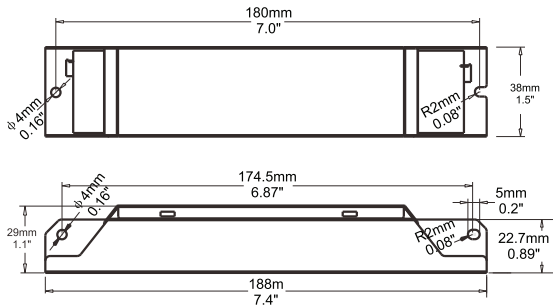

Battery A=(BLD-CM15H-YYY BLD-CM20H-YYY)

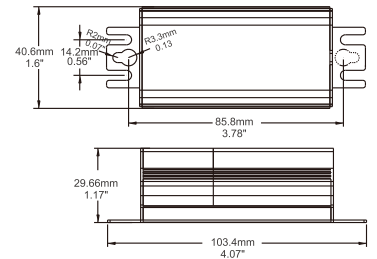

Battery B =(BLD-CM08H-YYY)

IMPORTANT SAFEGUARDS

When using electrical equipment, basic safety precautions should always be followed including the following:

READ AND FOLLOW ALL SAFETY INSTRUCTIONS.

- Risk of fire or electric shock. Luminaire wiring and electrical parts may be damaged when drilling for installation of LED Emergency Backup. Check for enclosed wiring and components.
- Risk of fire or electric shock. This LED Emergency Backup installation requires knowledge of luminaire electrical systems. If not qualified, do not attempt installation. Contact a qualified electrician.
- Before installing, make certain the AC power to the fixture is off.
- The electrical rating of this product is 100– 347Vac. Installer must confirm that there is 100– 347Vac to the fixture before installation.
- To prevent electrical shock only mate unit connector after installation is complete and before the AC power to the fixture is back on.
- Do not use in outdoor.
- This LED Emergency Backup unit requires an un-switched AC power source of 100– 347Vac, 50/60Hz. The AC driver must be on the same branch circuit as the LED Emergency Backup unit.
- Do not let power supply cords touch hot surfaces.
- Do not mount near gas or electric heaters.
- Do not connect battery pack connector until all other wiring is complete and AC power is on.
- The emergency LED driver is for use with grounded, UL listed LED luminaires, shall be enclosed by the LED luminaire and bonded to the grounding of LED luminaire.
- Verify that all replacement lamp types marked on the installed luminaire are also identified as suitable for use with this emergency battery pack.
- The battery pack is fixed by the screw and the indicator lamp is attached to the shell of the luminaire by 3M tape
- Equipment should be mounted in locations and at heights where it is not be subjected to tampering by unauthorized personnel.
- The use of accessory equipment is not recommended by the manufacturer and may cause an unsafe condition.
- Do not use this equipment for other than its intended use.
- Use with grounded, UL Listed, dry or damp location rated fixtures.