

# LED LINEAR HIGH BAY

LHB-2FTN-XXW / LHB-2FTW-XXW / LHB-4FTN-XXW



## INSTALLATION MANUAL



### HARDWARE INCLUDED

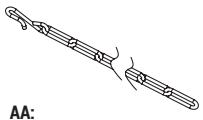

**AA:**  
Hanging chain (2)



**BB:**  
"V" hook (2)



**CC:**  
Wire nuts (5)

### TROUBLE SHOOTING

PROBLEM	POSSIBLE CAUSE	SOLUTION
Light will not come on	A. Light switch is turned off. B. Fuse is blown or circuit breaker is turned off. C. Incorrect circuit wiring.	A. Turn light switch on. B. Replace fuse or turn circuit breaker on. C. Verify that fixture is wired properly.

### ASSEMBLY INSTRUCTIONS

- NON-REPLACEABLE LEDs.
- IF YOU ARE NOT FAMILIAR WITH STATE AND LOCAL ELECTRICAL CODES, IT IS RECOMMENDED THAT YOU CONSULT WITH A QUALIFIED ELECTRICIAN.
- DO NOT USE IN WET LOCATIONS, USE INDOORS ONLY.
- **CAUTION:** LEDs EMIT BRIGHT LIGHT. AVOID LOOKING DIRECTLY INTO THE LIGHT SOURCE FOR PROLONGED PERIODS TO AVOID EYE DAMAGE.
- DIMMABLE WITH 0~10V DIMMER (SOLD SEPARATELY).
- MULTI-VOLT (100~277 VOLT) FOR COMMERCIAL OR RESIDENTIAL USE.

### SAFETY INFORMATION

PLEASE READ AND UNDERSTAND THIS ENTIRE MANUAL BEFORE ATTEMPTING TO ASSEMBLE, OPERATE OR INSTALL THE PRODUCT.

### WARNING

- Turn off electricity at main fuse box (or circuit breaker box) before beginning installation by removing fuse or switching off circuit breaker.
- Be careful not to damage or cut the wire insulation (covering) during fixture installation. Do not permit wires to contact any surface having a sharp edge. To do so may damage or cut the wire insulation, which could cause serious injury or death from electric shock.
- LED electronics can be damaged by electro static discharge (ESD) shock. Before installation, discharge yourself by touching a grounded bare metal surface to remove this hazard. To avoid damage, do not touch the LED module.

### CAUTION:

- All electrical connections must be in agreement with local codes, ordinances or the national electric code (NEC).
- Contact your municipal building department to learn about your local codes, permits and/or inspections.
- **RISK OF FIRE** – most dwellings built before 1985 have supply wire rated for 140°F/60°C. Consult a qualified electrician before installation.
- Do not connect this fixture to an electrical system that does not provide a means for equipment grounding. Never use a fixture in a two-wire system that is not grounded. If you are not sure your lighting system has a grounding means, do not attempt to install this fixture. Contact a qualified, licensed electrician for information with regards to proper grounding methods as required by the local electrical code in your area.
- If a dimmer control switch is used with this fixture, obtain professional advice to determine the correct type and electrical rating required.

### PRE-INSTALLATION

- BEFORE BEGINNING ASSEMBLY, INSTALLATION OR OPERATION OF PRODUCT, MAKE SURE ALL PARTS ARE PRESENT.
- COMPARE PARTS WITH PACKAGE CONTENTS LIST AND DIAGRAM ON PREVIOUS PAGE. IF ANY PART IS MISSING OR DAMAGED, DO NOT ATTEMPT TO ASSEMBLE, INSTALL OR OPERATE THE PRODUCT. CONTACT CUSTOMER SERVICE FOR REPLACEMENT PARTS.
- TOOLS REQUIRED FOR ASSEMBLY (NOT INCLUDED): SCREWDRIVER, PHILLIPS SCREWDRIVER, PLIERS, ELECTRICAL TAPE, WIRE CUTTERS, SAFETY GLASSES, LADDER, WIRE STRIPPER.

### CARE AND MAINTENANCE

**CAUTION:** Before attempting to clean the fixture, disconnect the power to the fixture by turning the breaker off or removing the fuse from the fuse box. This LED light fixture is made from quality materials that will last many years with minimum care and maintenance. You may want to clean the fixture with a soft cloth periodically. To maintain the best appearance of the fixture, do not use cleaners with chemicals, solvents or harsh abrasives. Do not use liquid cleaner on the LEDs, LED driver, or wiring inside the light fixture.

### INSTALLATION (CAUTION: BEFORE BEGINNING INSTALLATION TURN OFF THE CIRCUIT BREAKER AND LIGHT SWITCH.)

#### ATTACH THE CEILING HOOKS

Choose desired location of light fixture making sure it is within reach of an outlet. Use a pencil to place a mark on the ceiling where each ceiling hook (Part DD not included) should go. Screw hooks in place until secure.)

#### SUSPENDED TO CEILING

- Hook on the "V" hook (Part BB) across each hanging chain (Part AA). (Figure 2)
- Hook on the "V" hook (Part BB) across each hole on both sides of the fixture. (Figure 1)
- Hook on the hanging chains (Part AA) across each ceiling hook (Part DD not included). (Figure 1)

#### WIRING CONNECTION

1. Loosen the screw (Part A) by using the phillips screwdriver on the back of the fixture. (Figure 3)
2. Remove the access plate (Part B) and knockout a hole (Part C). (Figure 4)
3. Make wire connections in accordance with local codes by using the wire nuts (Part CC) to secure wiring connection. (Figure 4)
4. Replace the access plate (Part B) and tighten the screw (Part A). (Figure 5)

### FCC WARNING:

**WARNING:** Changes or modifications to this unit not expressly approved by the party responsible for compliance could void the user authority to operate the equipment.

**NOTES:** This equipment has been tested and found to comply with the limits for a Class B digital device, pursuant to Part 15 of the FCC Rules. These limits are designed to provide reasonable protection against harmful interference in a residential installation. This equipment generates, uses and can radiate radio frequency energy and, if not installed and used in accordance with the instructions, may cause harmful interference to radio communications.

However, there is no guarantee that interference will not occur in a particular installation. If this equipment does cause harmful interference to radio or television reception, which can be determined by turning the equipment off and on, the user is encouraged to try to correct the interference by one or more of the following measures:

- Reorient or relocate the receiving antenna.
- Increase the separation between the equipment and receiver.
- Connect the equipment into an outlet on a circuit different from that to which the receiver is connected.
- Consult the dealer or an experienced radio/TV technician for help.

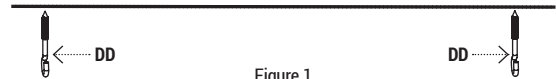

Figure 1

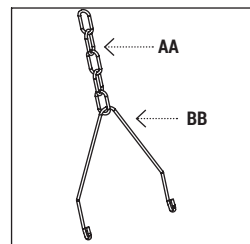

Figure 2

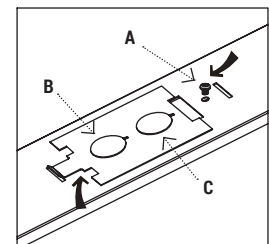

Figure 3

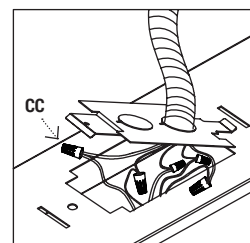

Figure 4

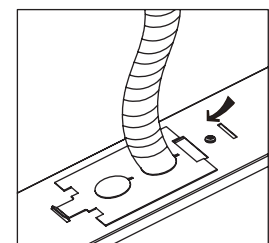

Figure 5