

LED GOOSENECK

BL-GSNKYD-42W-02W5 / BL-GSNKYD-42W-02B4



INSTALLATION MANUAL



HARDWARE INCLUDED (Some parts maybe pre-assembled)



AA:
Machine screws (2)



BB:
Machine screws (2)



CC:
Wire nuts (3)



DD:
Screw caps (2)

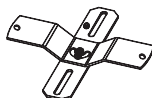

EE:
Mounting bracket (1)

PRE-INSTALLATION

- CAREFULLY REMOVE THE FIXTURE FROM THE CARTON
- BEFORE BEGINNING ASSEMBLY, INSTALLATION OR OPERATION OF PRODUCT, MAKE SURE ALL PARTS ARE PRESENT. COMPARE PARTS WITH PACKAGE CONTENTS LIST AND DIAGRAM ON PREVIOUS PAGE. IF ANY PART IS MISSING OR DAMAGED, DO NOT ATTEMPT TO ASSEMBLE, INSTALL OR OPERATE THE PRODUCT. CONTACT CUSTOMER SERVICE FOR REPLACEMENT PARTS.
- TOOLS REQUIRED FOR ASSEMBLY (NOT INCLUDED): SCREWDRIVER, PHILLIPS SCREWDRIVER, PLIERS, ELECTRICAL TAPE, WIRE CUTTERS, SAFETY GLASSES, LADDER, WIRE STRIPPER.

SAFETY INFORMATION

BE SURE THE POWER IS OFF! RISK OF ELECTRIC SHOCK: Always use the switch to power off. Do not perform any operations while this unit is powered on. The electrical system you want to connect the device to must be grounded. Read the instructions before using or powering this device. The safety instructions must be taken into account and respected in order to avoid user error, which can cause damages. The operating instructions must remain with the unit in case of transfer. Any damage to the device linked to an inappropriate use is excluded from support by the warranty. Before connecting, make sure that the current and voltage are compatible with this device. We highly recommend that all installations are made by a QUALIFIED ELECTRICIAN. We are NOT responsible by any means for the use or misuse of the following information. We are NOT responsible in whole or in part for any harm or damage that may or may not be caused. We reserve the right to revise the components of any product, due to part availability or change in ETL, CUL or UL standards without assuming any obligation or liability to modify any products previously manufactured and without notice. These instructions do not cover all details of variations in equipment, nor do they provide every possible contingency to be met. Turn off / unplug power when installing or servicing this device.

WARNING

WARNING: Read all safety precautions and installation instructions carefully before installing or servicing this fixture. Failure to comply with these instructions could result in a potentially fatal electric shock, fire, and/or property damage.

- To reduce the risk of electric shock or other personal injury which could be hazardous or fatal, ensure power is turned OFF at the fuse or breaker box before making any electrical connections or removing the old fixture.
- Changes or modifications not expressly approved by the party responsible for compliance could void the user's authority to operate the equipment.
- Must be connected to 100V-277V, 60 Hz power source.
- Fixture should be mounted to a grounded junction box marked for use in wet locations.
- Suitable for wall mount.
- Not suitable for ground locations. Minimum of 4 ft or higher.
- Fixture should be installed by a qualified electrician or person experienced with household wiring. The electrical system, and method of electrical connection of the fixture, must be in accordance with the National Electrical Code and local building codes.

SUITABLE FOR WET LOCATIONS

CONSULT A QUALIFIED ELECTRICIAN TO ENSURE CORRECT BRANCH CIRCUIT CONDUCTOR MINIMUM 90°C SUPPLY CONDUCTORS

THIS PRODUCT MUST BE INSTALLED IN ACCORDANCE WITH THE APPLICABLE INSTALLATION CODE BY A PERSON FAMILIAR WITH THE CONSTRUCTION AND OPERATION OF THE PRODUCT AND THE HAZARDS INVOLVED.

FCC WARNING:

WARNING: Changes or modifications to this unit not expressly approved by the party responsible for compliance could void the user authority to operate the equipment.

NOTES: This equipment has been tested and found to comply with the limits for a Class B digital device, pursuant to Part 15 of the FCC Rules. These limits are designed to provide reasonable protection against harmful interference in a residential installation. This equipment generates, uses and can radiate radio frequency energy and, if not installed and used in accordance with the instructions, may cause harmful interference to radio communications.

However, there is no guarantee that interference will not occur in a particular installation. If this equipment does cause harmful interference to radio or television reception, which can be determined by turning the equipment off and on, the user is encouraged to try to correct the interference by one or more of the following measures:

- Reorient or relocate the receiving antenna.
- Increase the separation between the equipment and receiver.
- Connect the equipment into an outlet on a circuit different from that to which the receiver is connected.
- Consult the dealer or an experienced radio/TV technician for help.

INSTALLATION (CAUTION: BEFORE BEGINNING INSTALLATION TURN OFF THE CIRCUIT BREAKER AND LIGHT SWITCH.)

PRE-ASSEMBLE FIXTURE

Connect Arm (C) and Lamp (A) through Swivel (D) and rotate Swivel to fasten two parts. Be careful not to misplace any of the hardware needed for installing the fixture.

NOTE: Tighten Swivel (D) until tight. Do not over tighten.

PARTS

- A - Lamp
- B - Lamp Shade
- C - Arm
- D - Swivel
- E - Set Screw

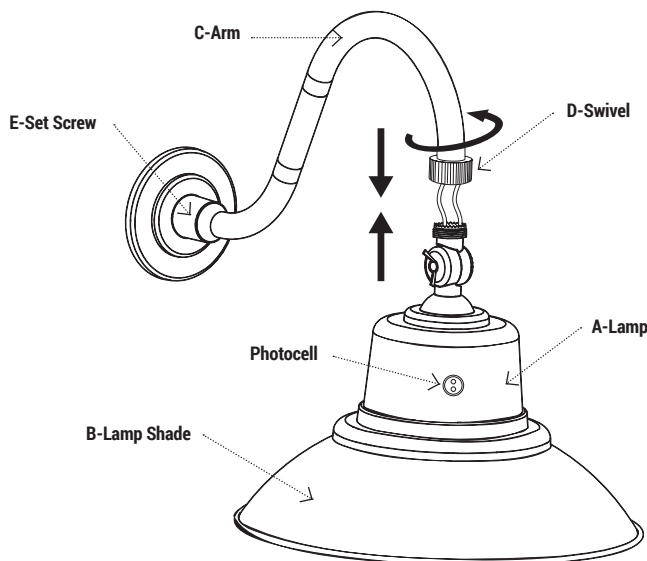
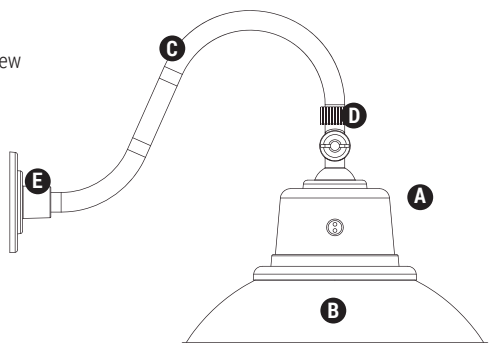

LED GOOSENECK

BL-GSNKYD-42W-02W5 / BL-GSNKYD-42W-02B4

INSTALLATION MANUAL

INSTALLATION (CAUTION: BEFORE BEGINNING INSTALLATION TURN OFF THE CIRCUIT BREAKER AND LIGHT SWITCH.)

IMPORTANT: DO NOT USE THIS FIXTURE WITH DIMMERS OR TIMERS

- This fixture is suitable for wall mount only.
- For best performance, mount the fixture 2.4 - 3.6 m / 8-12 ft. above the ground.

PULL THE WIRE OUT FROM JUNCTION BOX

Pull the supply wire (**Line, Neutral and Ground**) out from the junction box through the large center hole in the **Mounting bracket (EE)**. **Figure 1**

ATTACH MOUNTING BRACKET

Attache **Mounting bracket (EE)** to the junction box using the **Mounting screws (AA)**. **Figure 2**

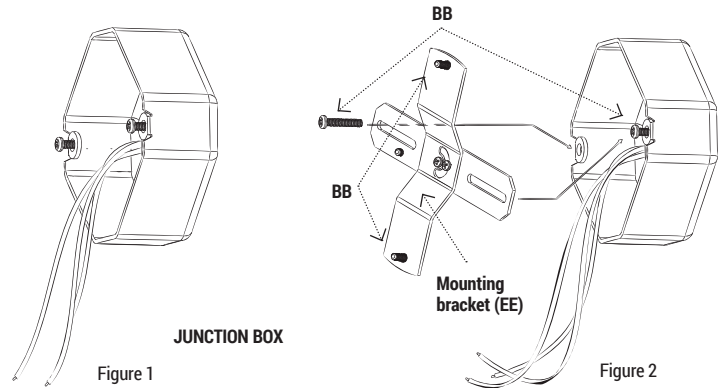

ATTACH POWER SUPPLY WIRE

1. Connect the fixture ground wire (**Green**) to the ground supply wire using a wire nut (**CC**).
2. Connect the **Black** fixture wire to the **Black (Line)** supply wire using a wire nut (**CC**).
3. Connect the **White** fixture wire to the **White (Neutral)** supply wire using a wire nut (**CC**).
4. Carefully tuck all wiring back into the junction box, making sure there are no exposed un-insulated wires. **Figure 3**

NOTE: For proper connection, place the wire nuts over the wires and twist clockwise until tight.

RECOMMENDED: Wrap each wire nut with electrical tape (not included).

ATTACH WALL CANOPY

Place the wall canopy over the junction box and onto the fixture's **Mounting screws (BB)** and adjust the fixture **Mounting screws (BB)** until they protrude out an appropriate height from the back of the wall canopy to allow the **Screw caps (DD)** to hold the wall canopy tightly against the wall. Remove the wall canopy and secure the position of the **Mounting screws (BB)** against the **Mounting bracket (EE)**. **Figure 3**

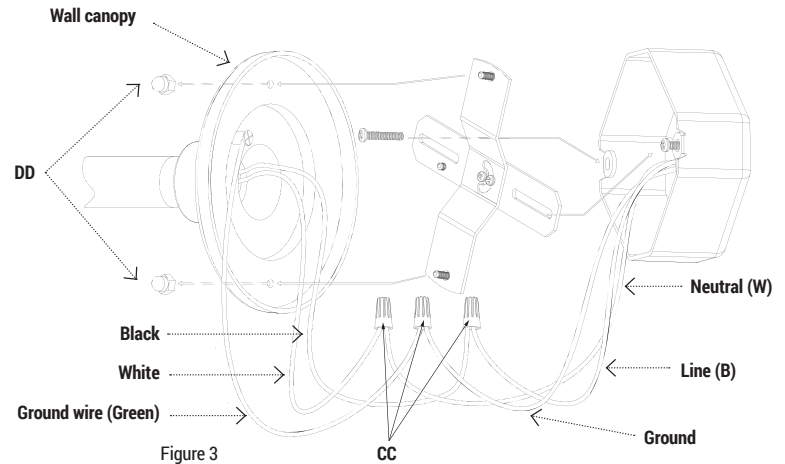

ADJUST FIXTURE ANGLE:

Adjust the fixture angle by rotating the swivel and butterfly bolt as shown in the illustration. Loosen butterfly bolt to adjust lamp shade and tighten when desired position reach.

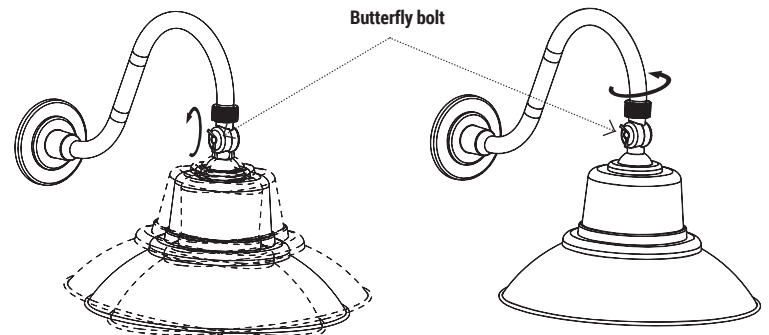

| | LUX | PHOTOCELL | FIXTURE |
|-------------|-------------------------|------------------------|------------|
| DUSK | <60 Lux 60-120 Lux | Activates No Action | ON ON |
| DAWN | >120 Lux 120-160 Lux | Activates No Action | OFF OFF |

TROUBLE SHOOTING

| PROBLEM | POSSIBLE CAUSE | SOLUTION |
|------------------------|--|--|
| Light will not come on | A. Light switch is turned off. B. Fuse is blown or circuit breaker is turned off. C. Incorrect circuit wiring. | A. Turn light switch on. B. Replace fuse or turn circuit breaker on. C. Verify that fixture is wired properly. |

CARE AND MAINTENANCE

CAUTION: Before attempting to clean the fixture, disconnect the power to the fixture by turning the breaker off or removing the fuse from the fuse box. This LED light fixture is made from quality materials that will last many years with minimum care and maintenance. You may want to clean the fixture with a soft cloth periodically. To maintain the best appearance of the fixture, do not use cleaners with chemicals, solvents or harsh abrasives. Do not use liquid cleaner on the LEDs, LED driver, or wiring inside the light fixture.